

OHIO

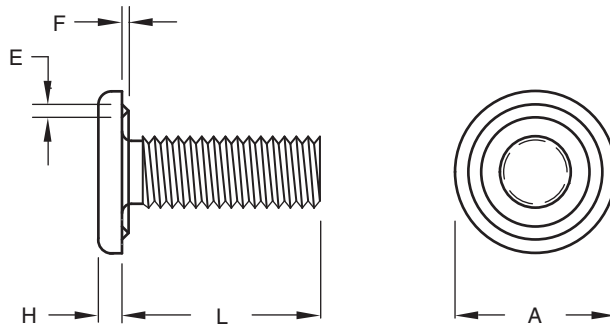

Recommended hole in sheet is .015 above the major diameter.

RWM Metric Weld Screw

Thread Size		M3.5 x 0.6-6g	M4 x 0.7-6g	M5 x 0.8-6g	M6 x 1-6g	M8 x 1.25-6g	M10 x 1.5-6g
Head	A-Diameter	8.0 +0.2 -0.3	9.3	11.6 +0.2 -0.3	14.0 ±0.3	18.8 ±0.4	23.0 ±0.4
	H-Height	1.2 ±0.13	1.3 ±0.13	1.6 ±0.13	1.9 ±0.13	2.5 ±0.13	3.1 ±0.13
Projections	E-Width (Ref.)	0.64	0.79	0.89	1.22	1.53	1.73
	F-Height	0.30 +0.08 -0.05	0.38 +0.08 -0.05	0.43 +0.08 -0.05	0.61 +0.08 -0.05	0.76 +0.08 -0.05	0.86 +0.08 -0.05
Length L Tol. Up to 25mm + 0.0 - 0.8 Tol. Over 25mm to 50mm + 0.0 - 1.6	10.0	RWM03510	RWM04010				
	14.0		RWM04014	RWM05014	RWM06014		
	16.0				RWM06016	RWM08016	
	20.0			RWM05020	RWM06020	RWM08020	RWM10020
	25.0		RWM04025		RWM06025	RWM08025	RWM10025
	35.0				RWM06035	RWM08035	RWM10035
50.0					RWM08050		
Material: C1010 High-Welding Quality, Low Carbon Steel							
Finish: Plain, Unless Specified							

Thread Size		M8 x 1.25-6g	M10 x 1.5-6g
Head	A-Diameter	18.8 ±0.4	23.0 ±0.4
	H-Height	2.5 ±0.13	3.1 ±0.13
Projections	E-Width (Ref.)	1.53	1.73
	F-Height	0.76 +0.08 -0.05	0.86 +0.08 -0.05
Length L Tol. Up to 25mm + 0.0 - 0.8 Tol. Over 25mm to 50mm + 0.0 - 1.6	16.0	RWH 08016	
	20.0	RWH 08020	RWH 10020
	25.0	RWH 08025	RWH 10025
	30.0	RWH 08030	RWH 10030
	35.0	RWH 08035	RWH 10035
	40.0	RWH 08040	RWH 10040
Material: C1022 HT RC 27-34			
Finish: Plain, Unless Specified			
Threads: ASME B1.13-2005			

RWH Metric Weld Screw

The RWM (C1010 steel) and RWH (C1022 steel RC 27-34) Metric weld screws, for through-hole applications, feature a 360 degree ring projection that provides a circular weld seal. The large weld area on these screws provides additional weld strength. The full ring projection is also ideal for cross wire welding or welding to screen or perforated metal or tubing. Ring projections are often used in air conditioning and refrigeration applications where a leak proof seal is needed. The RWH series allows for greater installation torque in heavy duty applications.



The Ohio Nut and Bolt Company

Sales Office: Buckeye Fasteners • "Your Factory Source"

5250 West 164th Street • Cleveland Ohio 44142

Ph: (800)-437-1689 • Ph: (216)-267-2240 • Fax: (216) 267-3228

www.BuckeyeFasteners.com

A Division of Fastener Industries Inc. — An Employee Owned Company

© Copyright 2012 The Ohio Nut and Bolt Company

