

**Self
Clinching
Stud**

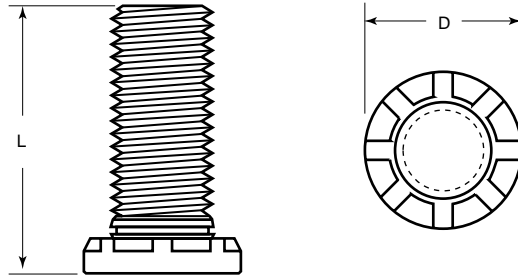

**Product
Specification
Sheet**

Thread Size	#2-56	#4-40	#6-32	#8-32	#10-24	#10-32	1/4-20	5/16-18
Head Diameter – D ± 0.015	0.144	0.176	0.206	0.237	0.256	0.250	0.337	0.376
Hole in Sheet +0.003 / -0.000	0.085	0.111	0.137	0.163	0.189	0.189	0.249	0.311
Max. Recommended Torque For Mating Part (IN. LBS.)	2.5	5.0	10.0	15.0	25.0	30.0	55.0	115.0
Length – L	0.250	256-4	440-4	632-4	832-4	1024-4	1032-4	
	0.312	256-5	440-5	632-5	832-5	1024-5	1032-5	
	0.375	256-6	440-6	632-6	832-6	1024-6	1032-6	420-6
	0.500	256-8	440-8	632-8	832-8	1024-8	1032-8	420-8 518-8
	0.625	256-10	440-10	632-10	832-10	1024-10	1032-10	420-10 518-10
	0.750		440-12	632-12	832-12	1024-12	1032-12	420-12 518-12
	0.875		440-14	632-14	832-14	1024-14	1032-14	420-14 518-14
	1.000		440-16	632-16	832-16	1024-16	1032-16	420-16 518-16
	1.250			632-20	832-20	1024-20	1032-20	420-20 518-20
1.500			632-24	832-24	1024-24	1032-24	420-24 518-24	

Note: Part numbers are incomplete. Add the prefix which is applicable to the material you require. Example: BFH 256-4, Carbon steel, heat treated, zinc plated w/clear chromate, Thread size #2-56, length of .250 inches

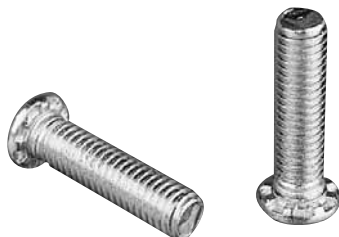

Material:
 BFH – Carbon Steel, heat treated, zinc plated w/clear chromate
 BFHS – 300 series stainless steel, passivated
 BFHA – 2024-H-13 Aluminum, heat treated
 Threads: Unified Standard Class 2A per ASME B1.1-2003

Minimum Sheet Thickness040
 Maximum recommended panel hardness:
 BFH: Rockwell B80
 BFHS: Rockwell B70
 BFHA: Rockwell B50



Buckeye Fasteners, Inc.

5250 West 164th Street • Brook Park, Ohio 44142-1597

(800) 437-1689 • Fax: (216) 267-3228

buckeyefasteners.com • info@buckeyefasteners.com

© 2007 Buckeye Fasteners, Inc. All Rights Reserved

