

**Metric Weld  
Screw Three  
Projections  
On Top Of  
Head**

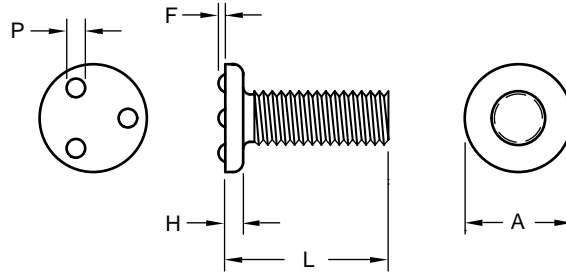

**Product  
Specification  
Sheet**

Thread Size		M3.5 x 0.6-6g	M4 x 0.7-6g	M5 x 0.8-6g	M6 x 1-6g	M8 x 1.25-6g	M10 x 1.5-6g
Head	A-Diameter	7.0 ± 0.25	8.0 ± 0.25	10.0 ± 0.25	12.0 ± 0.30	16.0 ± 0.30	20.0 ± 0.40
	H-Height	1.1 ± 0.13	1.2 ± 0.13	1.6 ± 0.13	1.9 ± 0.13	2.5 ± 0.13	3.1 ± 0.13
Projections	P-Diameter	1.40 ± 0.13	1.78 ± 0.13	2.13 ± 0.13	2.54 ± 0.13	3.10 ± 0.13	3.56 ± 0.13
	F-Height	0.53 ± 0.05	0.64 ± 0.05	0.81 ± 0.05	1.02 ± 0.05	1.20 ± 0.05	1.40 ± 0.05
Length (Overall) L	6.0	GWM 03506	GWM 04006				
	8.0	GWM 03508	GWM 04008				
Tolerance Up to 25mm + 0.0 - 0.8	10.0	GWM 03510	GWM 04010	GWM 05010	GWM 06010		
	12.0	GWM 03512	GWM 04012	GWM 05012	GWM 06012		
Over 25mm to 50mm + 0.0 - 1.6	14.0	GWM 03514	GWM 04014	GWM 05014	GWM 06014		
	16.0	GWM 03516	GWM 04016	GWM 05016	GWM 06016	GWM 08016	
Over 50mm + 0.0 - 2.3	20.0	GWM 03520	GWM 04020	GWM 05020	GWM 06020	GWM 08020	GWM 10020
	25.0	GWM 03525	GWM 04025	GWM 05025	GWM 06025	GWM 08025	GWM 10025
	30.0		GWM 04030	GWM 05030	GWM 06030	GWM 08030	
	35.0			GWM 05035	GWM 06035	GWM 08035	GWM 10035
	40.0			GWM 05040	GWM 06040		
	45.0			GWM 05045		GWM 08045	GWM 10045
	55.0						GWM 10055



An OHIO GWM weld screw has three projections on top of the head for welding to the sheet surface, not through it. From a design standpoint, the GWM screw will eliminate the necessity for holes, thus is ideal for those applications where product appearance or potential leakage is a prime consideration. There are no screw heads to protrude or spoil appearance or the product. With GWM screws, the exterior surface is left virtually unmarred. The GWM weld screw is an excellent choice for blind locations too, because it can be permanently pre-attached.

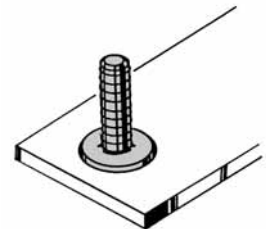

Material: .....C1010 High-Welding  
Quality, Low Carbon Steel  
Finish: .....Plain, Unless Specified  
Threads: .....ASME B1.13M-2005

Tensile Strength: .....60,000 psi  
Yield Point: .....30,000 psi  
Shear Strength: .....30,000 psi  
Elongation 2" .....30% Max.



**Buckeye Fasteners, Inc.**

5250 West 164th Street • Brook Park, Ohio 44142-1597

**(800) 437-1689 • Fax: (216) 267-3228**

buckeyefasteners.com • info@buckeyefasteners.com

© 2007 Buckeye Fasteners, Inc. All Rights Reserved

